



IN-STORE ASSEMBLY INSTRUCTIONS

ZERO TURN MOWER

MODEL NUMBER ZT4200L/ZT4200L-FC

A. UNPACKING

⚠ WARNING: To reduce the risk of injury or mower damage, do not use a knife to cut the nylon straps. Use scissors or side cutters.

⚠ WARNING: To reduce the risk of damage, remove watches or other fragile and valuable items from your wrists. There's a risk of accidental contact with steel frame elements.

Recommended tools for unpacking (not included):

- Scissors or side cutters.
- Impact wrench with 1/2 in (13 mm) socket.

1. Remove the plastic cover from the mower.
2. Cut the nylon straps and remove the accessory box located in the center seat area of the mower and remove the two open-end wrenches inside. (See Fig. 1).
3. Use the two open-end wrenches* to remove all 18 bolts that hold together the frame in the order shown in Fig. 1.

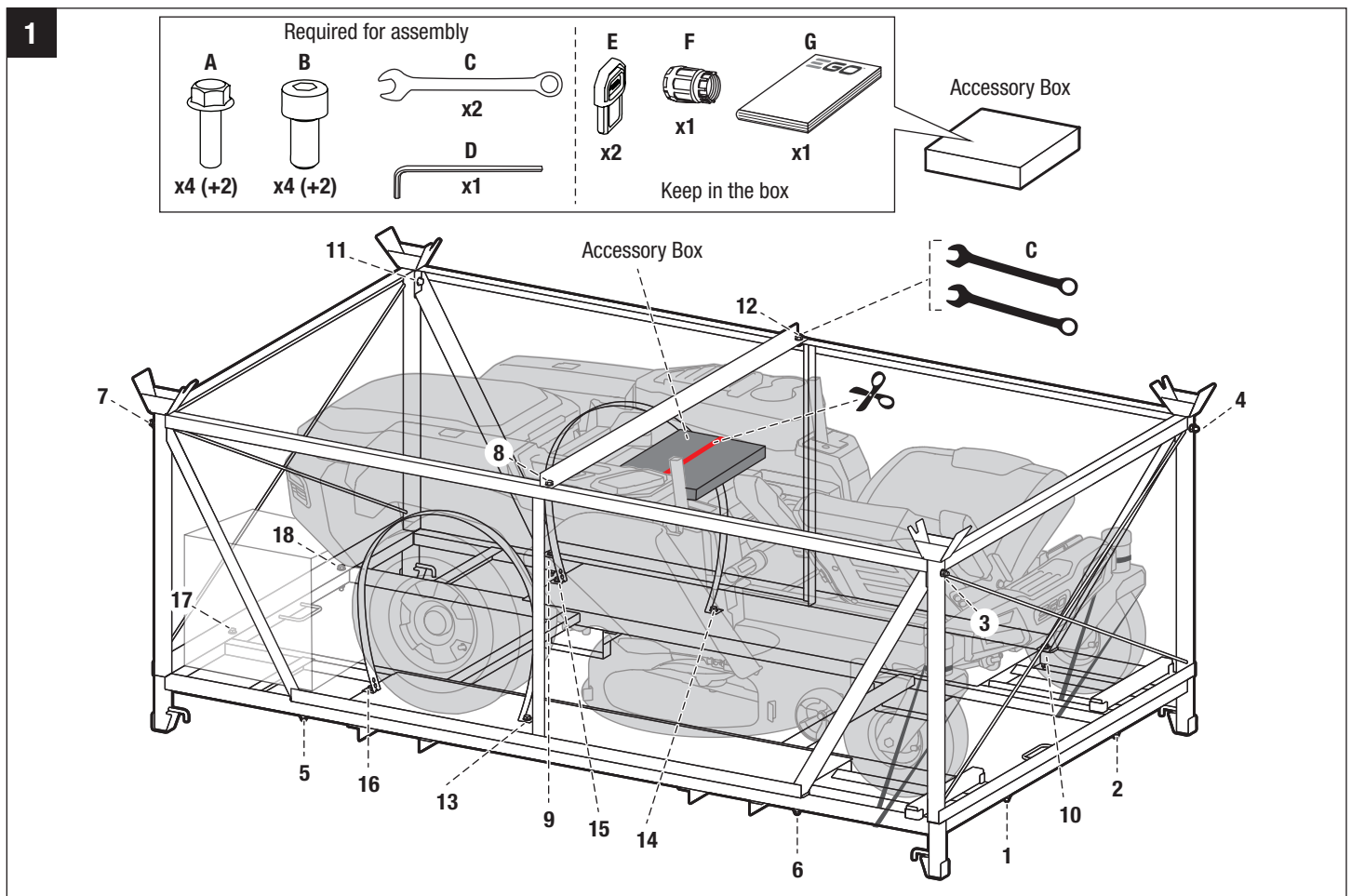

If any parts are missing, please call 1-800-346-9876

4. Cut the nylon straps securing the battery/charger boxes, seat, steering levers, mower front wheels, and side-discharge chute (See Fig. 2).
5. Remove the seat assembly and the two steering levers from the mower first, and then remove the battery and charger boxes from the bottom of the frame (Fig. 2). **Do not open the battery and charger boxes! Hand them to the store manager.**
6. Remove and set aside all accessible packaging and wrap. Do not discard the packing material until you have carefully inspected the product.
7. Remove both Wheel Chocs from in front of the wheels. You may need to use the included wrench to pry off the chocs (Fig. 2)
8. If a ramp is available, position a full-width ramp against the bottom frame, close to the front wheels. Do not exceed the maximum recommend operating angle of 15°.

9. Press the Parking Brake Pedal to release it from the braking position. A significant effort is required to release the parking brake pedal by hand. Push hard!

⚠ CAUTION: Heavy object. Team push required. At least two persons are required to push this mower off of the steel frame.

10. Grasp the steering lever Mounting Pole and the rear part of the mower simultaneously on both sides and slowly push the mower out of the steel frame in the forward direction (Fig.7).

⚠ CAUTION: ONLY PUSH THE MOWER FORWARD. Pulling the mower backward from the steel frame may cause damage the mower's cutting deck. **Always remove the mower from the frame in the forward direction!**

- Inspect the product carefully to make sure that no breakage or damage occurred during shipping.
- If any parts are damaged or missing, please contact EGO after sale service.

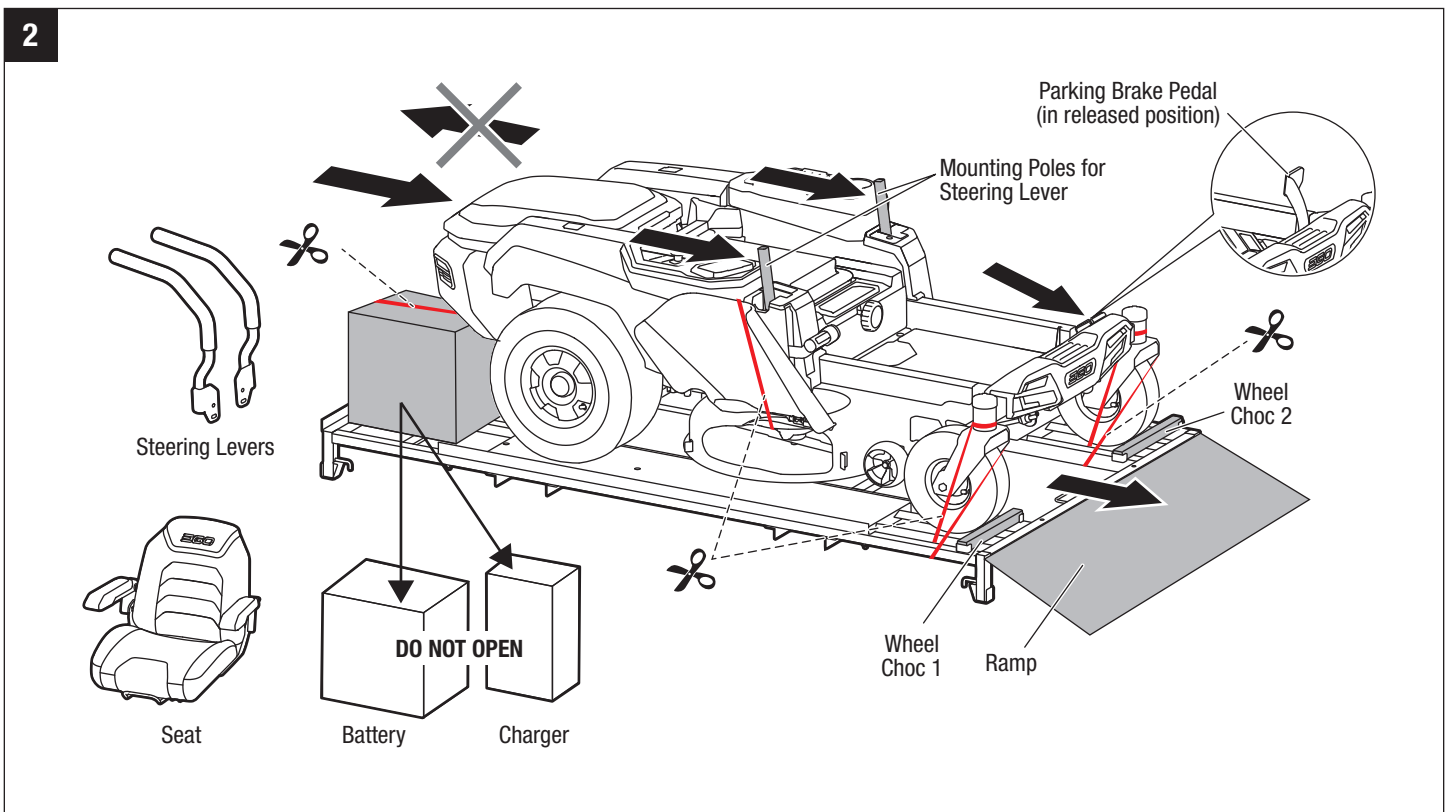

B. SEAT INSTALLATION

The mower incorporates a safety interlock system that will stop the drive motors and deck motors when the operator is unseated for any reason while the mower is operating. This is a safety feature designed to prevent runaway or accidental entanglement.

1. Lay the seat on its side and insert the cable plug into the socket on the bottom of the seat (Fig. 3). This connects the safety interlock system.

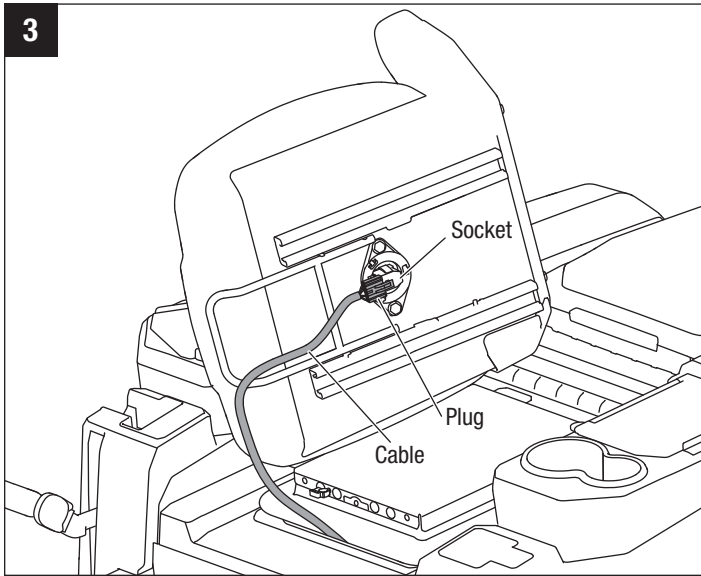

2. Rotate the two arm rests to the horizontal positions. Place the seat closely against the front of the suspension base. Align the two mounting holes in the seat with the holes in suspension base, and use the Allen key **D** to secure the seat to the suspension base with the two socket-head screws **B** (Fig. 4).

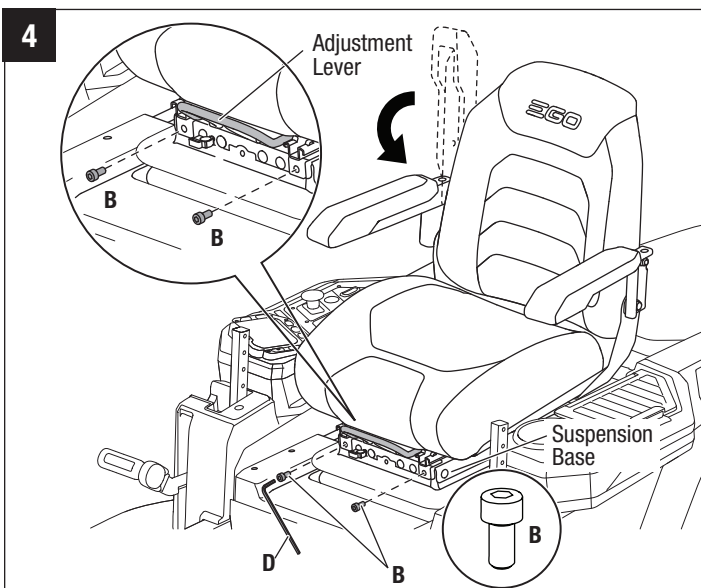

3. Lift the adjustment lever slightly and pull the seat forward to expose the two backside mounting holes in the steel rails of the seat assembly (Fig. 4).
4. Use the Allen key **D** to thoroughly tighten the steel rails onto the suspension base with the remaining two socket head screws **B** (Fig. 5).

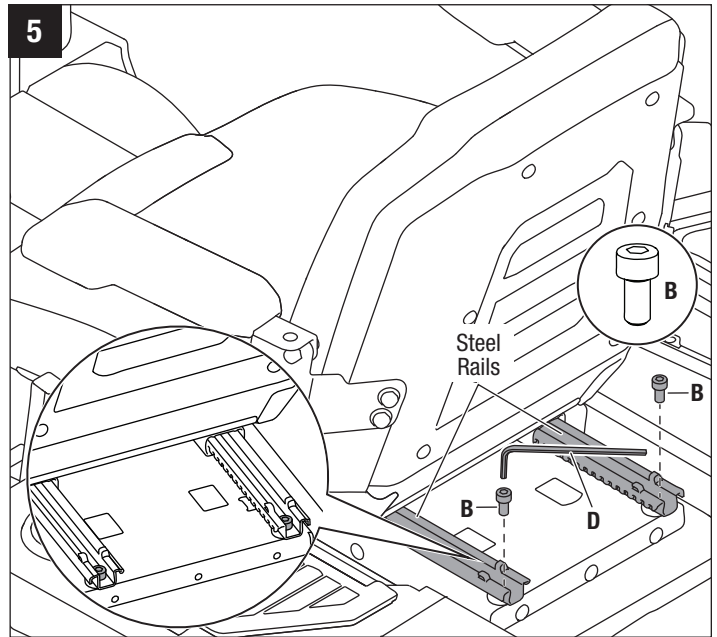

⚠ WARNING: When finishing tightening the two backside screws, please check that there is no gap between the front part of the steel rails and the suspension base.

5. Place the flexible cable into the hook as the indicated position label on the cable shows (Fig. 6).

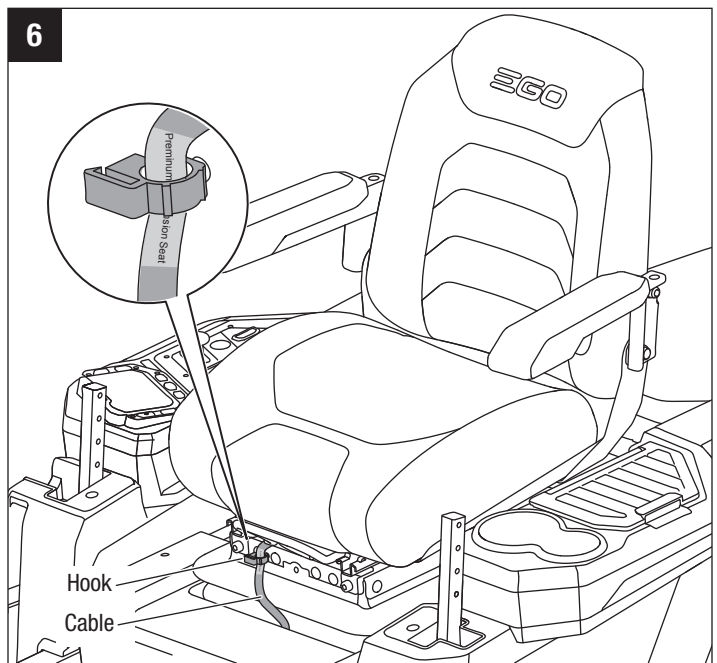

C. ATTACHING THE STEERING LEVERS

- Lift one steering lever to align the holes in the steering lever with the holes in the corresponding mounting pole. Select the preferred steering lever operating height:
 - Upper two holes in the mounting pole;
 - Middle two holes in the mounting pole;
 - Bottom two holes in the mounting pole.
- Use two bolts **A** to attach the steering lever to the mounting pole using the wrench **C** (Fig. 7).
- Attach the other steering lever in the similar fashion using the same pair of holes on the other mounting pole. NEVER install the steering levers at an asymmetrical height.

⚠ The left and right steering levers should be adjusted so that they align with each other when in the neutral position.

D. CHECKING THE TIRE PRESSURE

Check the air pressure in all tires before use. Be sure tires are inflated to the pressure shown below.

⚠ Tire pressure should only be measured or adjusted when tires are cold.

| Recommended Pressure | |
|----------------------|------------------|
| Front Wheels | Rear Wheels |
| 32 PSI (222.1 kPa) | 7 PSI (48.3 kPa) |

E. LEVELING THE MOWER DECK

⚠ WARNING: Always protect your hands by wearing heavy gloves or wrapping the cutting edges with rags or other materials when performing any maintenance on the mower blade.

TOOLS REQUIRED:

- one 13/16 in (21mm) open-end wrench
- one 23/32 in (18mm) open-end wrench
- leveling gauge for mower deck

To Make Side-to-Side Adjustment

- Place the mower on a level surface and engage the parking brake pedal.
- Make sure that the batteries have been removed from the mower before making any adjustments.
- Raise the mower deck to its maximum height:

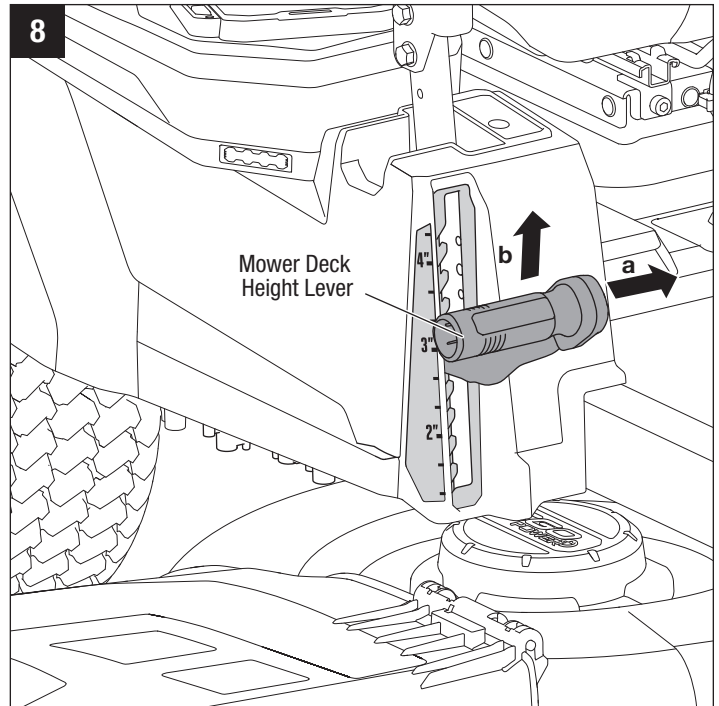
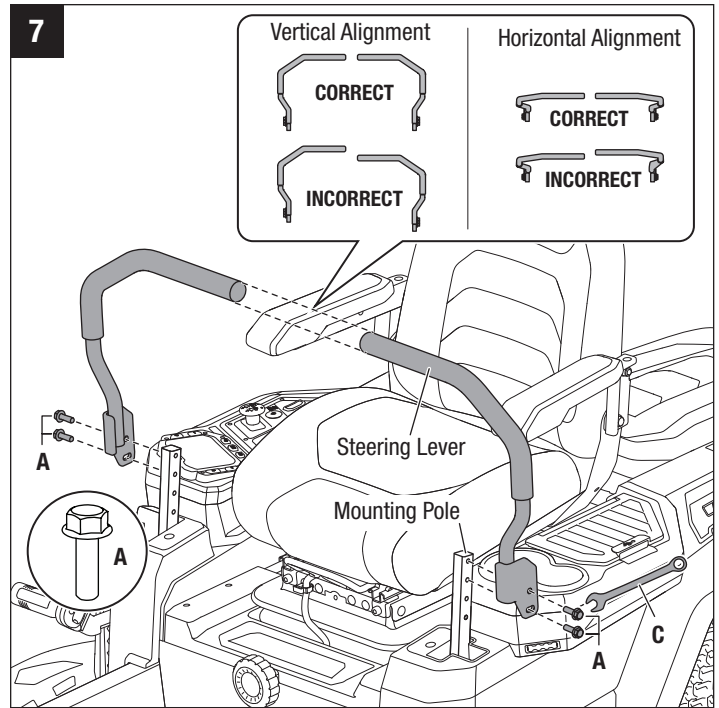

- Grasp the deck-height adjustment lever and move it inwards to disengage it from the slot (Fig. 8).
- Lift the lever all the way and engage it into the highest slot. Mower deck anti-scalp wheels should not contact the ground when leveling the deck (Fig. 8).

4. Position both blades so that the ends point toward the sides of the mower (Fig. 9).
5. On the outside edge of each blade, measure the distance **X** from the bottom edge of the side of the blade to the ground (Fig. 10). If the difference between the distances **X** on two sides is greater than $\frac{13}{64}$ in (5mm), side-to-side adjustment is necessary.
6. On the side you wish to adjust, use a $\frac{13}{16}$ in (21mm) open-end wrench to adjust the one jam nut on the back of the mower (Fig. 11).
7. Measure again. Continue to adjust and measure until the difference between the distances **X** on each side is within $\frac{13}{64}$ in (5mm).
8. Proceed to front-to-back adjustment or retighten the nuts.

NOTE: in case of the jam nut on the back is removed from the tool accidentally, remount it with the shoulder of the jam nut facing outward. No requirement for the two nuts on the suspension linkage.

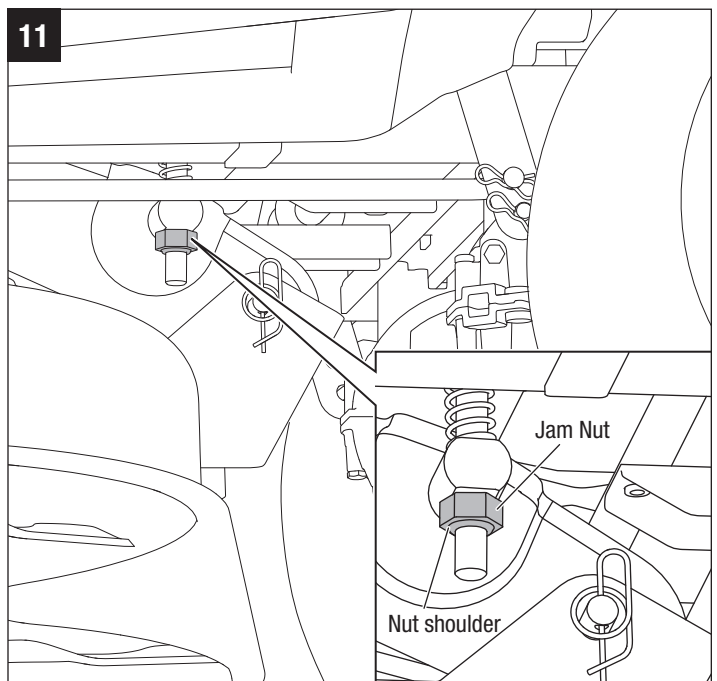
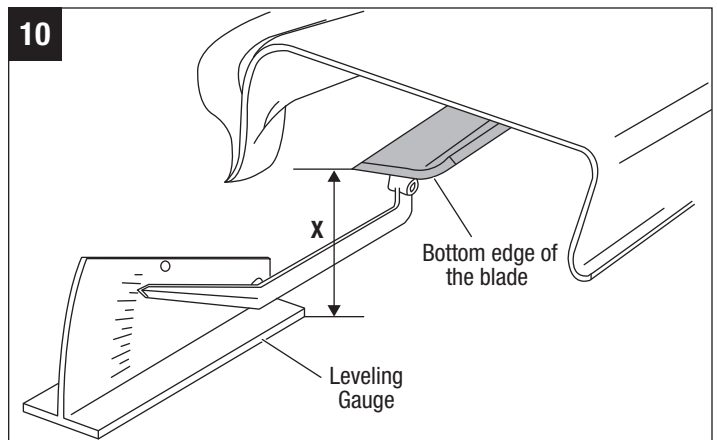
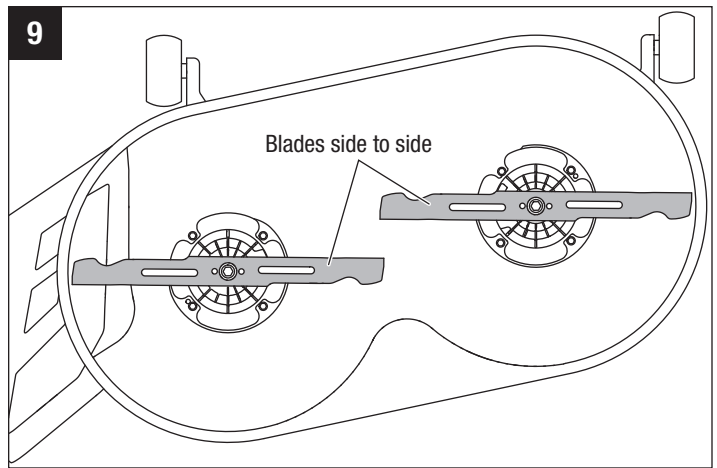

To Make Front-to-Rear Adjustment

ATTENTION: Always level the deck side-to-side before making a front-to-rear adjustment.

1. Position both blades so that the ends point toward the front and back of the mower (Fig. 12).
2. Measure the distance **X** from the tip of one blade to the ground (see Fig. 13). For best results, the front tip of the blade should be from $\frac{5}{64}$ in to $\frac{25}{64}$ in (2mm to 10mm) lower than the rear tip.
3. If front-to-rear adjustment is needed, use a $\frac{23}{32}$ in (18mm) open-end wrench to adjust the four nuts on the suspension linkage (two for each side). See Fig. 13.

ATTENTION: Make sure to turn the corresponding nuts on both sides equally to avoid altering the side-to-side measurement.

4. Measure again to verify that the front tip is now $\frac{5}{64}$ in to $\frac{25}{64}$ in (2mm to 10mm) lower than the rear tip. If not, continue to adjust and measure until they are.
5. Retighten the nuts. The recommended torque for the nuts is 38-42 ft-lb (52-57N.m).

